

Easy Drain®

Compact

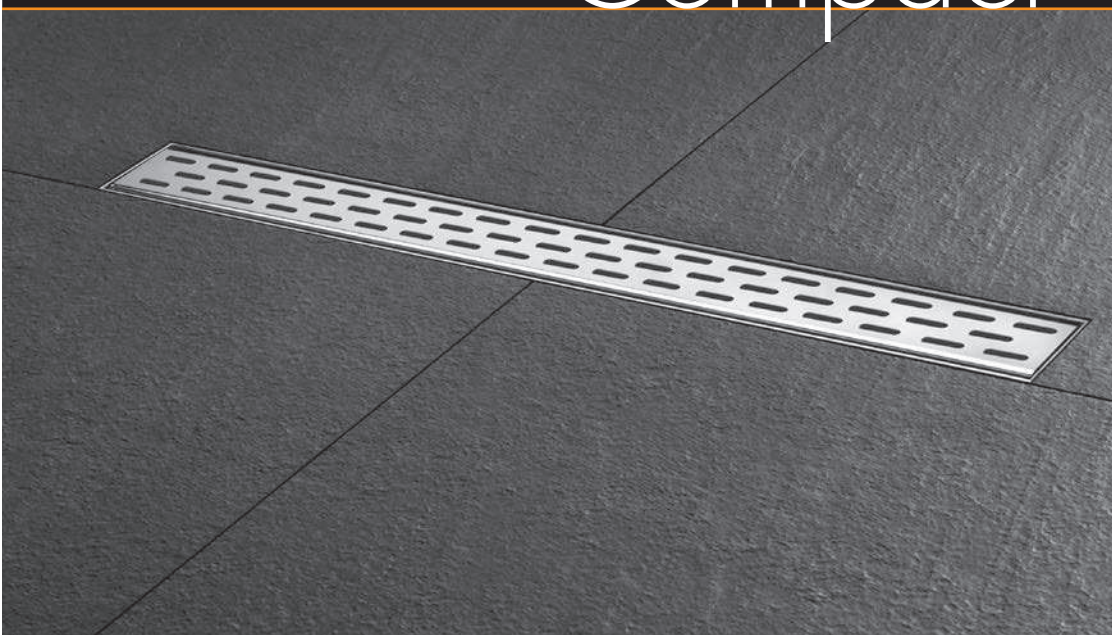

0,42 l/s  
  
MIN. CAPACITY

0,70 l/s  
  
MAX. CAPACITY

UK	<b>INSTALLATION ADVICE</b>
DE	Einbauempfehlung
NL	Inbouwadvis
DK	Montagevejledning
NO	Innbyggingsråd
ES	Consejo para la instalación
PT	Conselho de instalação
IT	Consigli di montaggio
FR	Conseils de montage
PL	Zalecenia dotyczące wbudowania

**UK Contents**  
**DE Inhalt**  
**NL Inhoud**  
**DK Indhold**  
**NO Innhold**

**ES Contenido**  
**PT Conteúdo**  
**IT Contenuto**  
**FR Table des matières**  
**PL Zawartość**

Installation options .....	3
Height adjustable support .....	4
Installation guide .....	5
Sealing advice .....	7
Maintenance instructions .....	8
Siphon cleaning .....	9
Important assembling advice .....	10

**Compact**



**Compact TILE**



**Compact WALL**



**UK** Installation options  
**DE** Einbaumöglichkeiten  
**NL** Inbouwvarianten  
**DK** Installeringsvarianter  
**NO** Innbyggingsvarianter

**ES** Opciones de instalación  
**PT** Variantes de instalação  
**IT** Varianti di montaggio  
**FR** Variantes de montage  
**PL** Warianty wmontowania

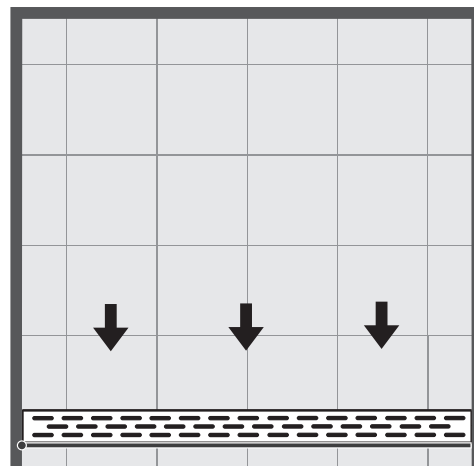
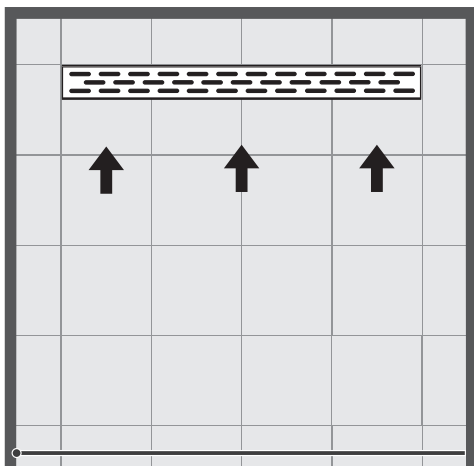
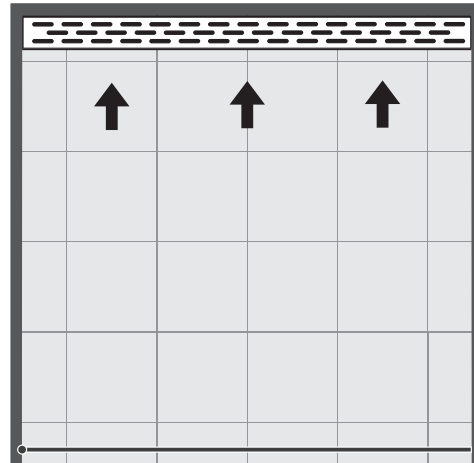
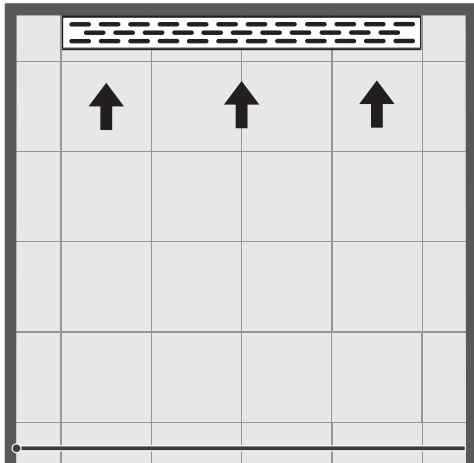

**UK** Height adjustable support

**DE** Stellfuß Montage

**NL** Stelvoet montage

**DK** Justering fod montering

**NO** Justeringsfot montering

**ES** Montaje del pie de ajuste

**PT** Montagem do pé nivelador

**IT** Montaggio del piede di regolazione

**FR** Socle de montage ajustable

**PL** Montaż na regulowanej stopce

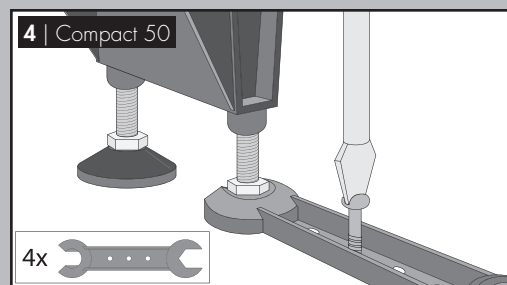
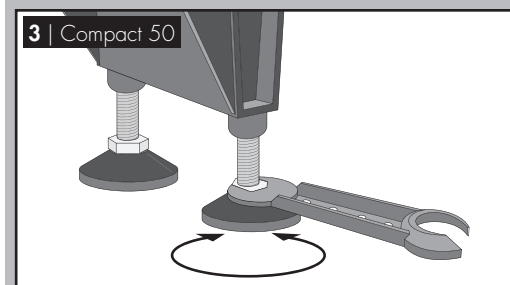
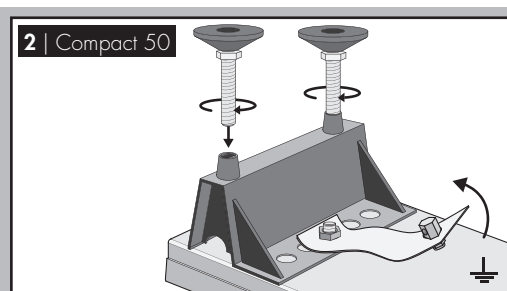
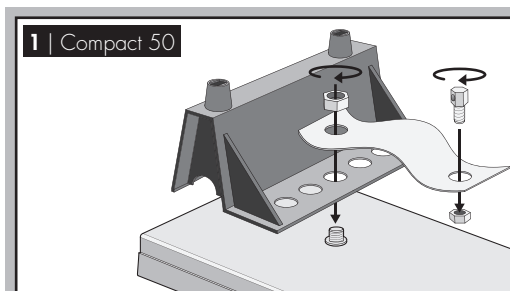
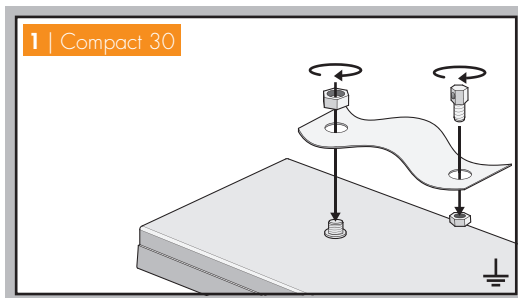

UK Installation guide  
 DE Einbauempfehlung  
 NL Inbouwhandleiding  
 DK Montagevejledning  
 NO Innbyggingsveiledning

ES Manual de instalación  
 PT Instruções de instalação  
 IT Istruzioni di montaggio  
 FR Explications de montage  
 PL Instrukcja wmontowania

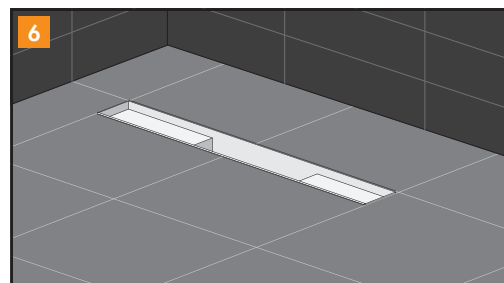
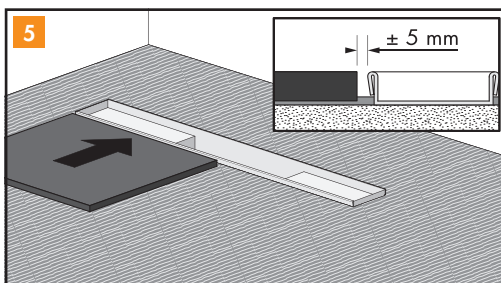
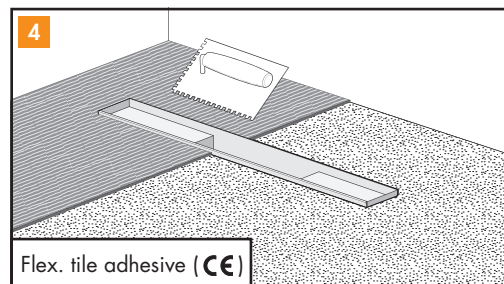
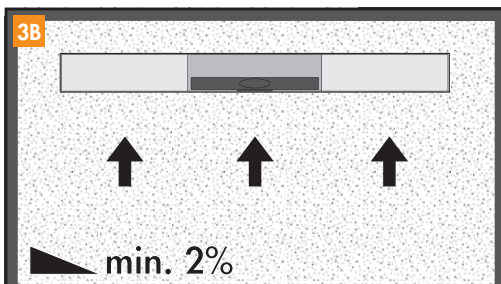
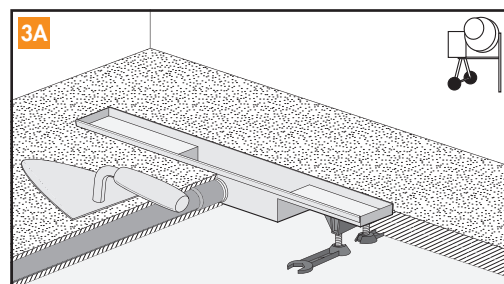
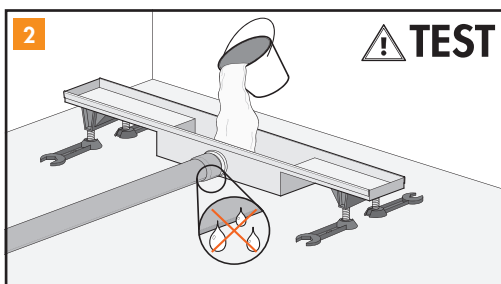
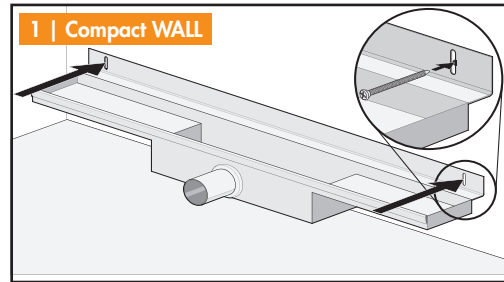
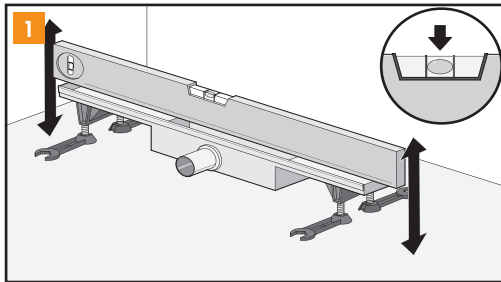

# Easy Drain®

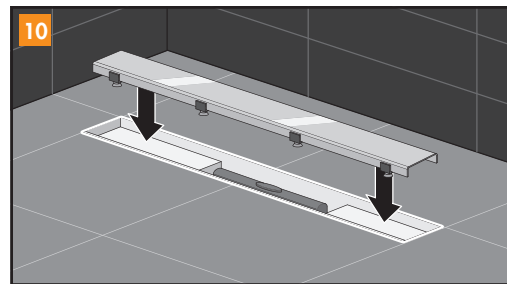
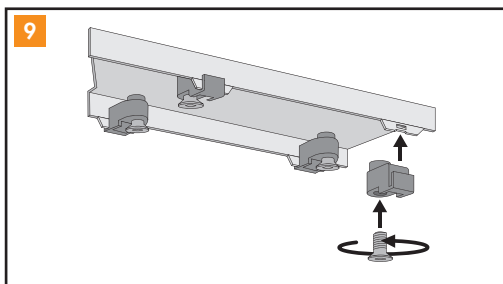
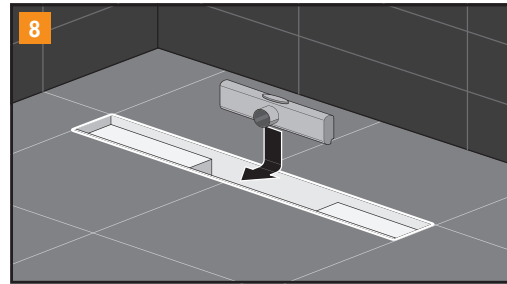
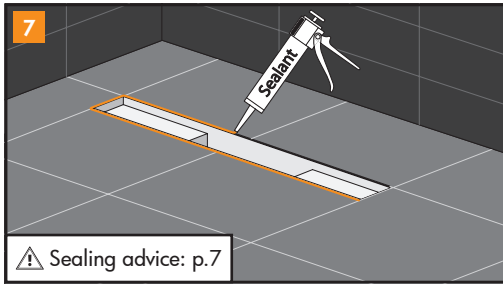

**UK** Sealing advice  
**DE** Abdichtungsempfehlung  
**NL** Afdichtingsadvies  
**DK** Tætningsråd  
**NO** Tetningsråd

**ES** Consejo de sellado  
**PT** Conselho de vedação  
**IT** Consigli per la sigillatura  
**FR** Conseil pour étanchéifier  
**PL** Zalecenia dotyczące uszczelniania

**UK** Only primary drainage  
**DE** Nur Primärwasser Ableitung  
**NL** Alleen primaire afwatering  
**DK** Kun afledning af primærvand  
**NO** Kun primær avløp

**ES** Sólo desagüe de agua primario  
**PT** Só drenagem da água primária  
**IT** Solo derivazione primario scarico  
**FR** Seule évacuation primaire  
**PL** Podstawowy systemu odpływowego

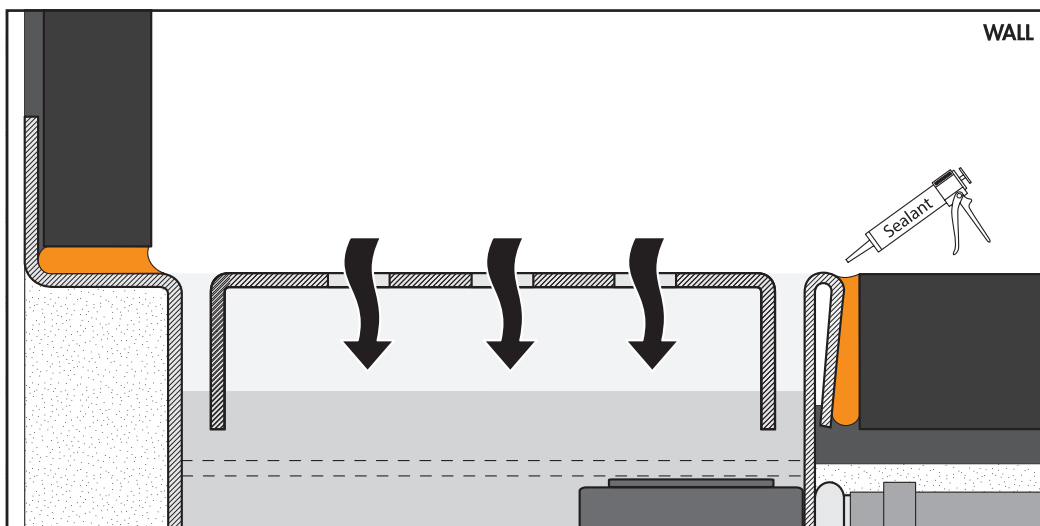
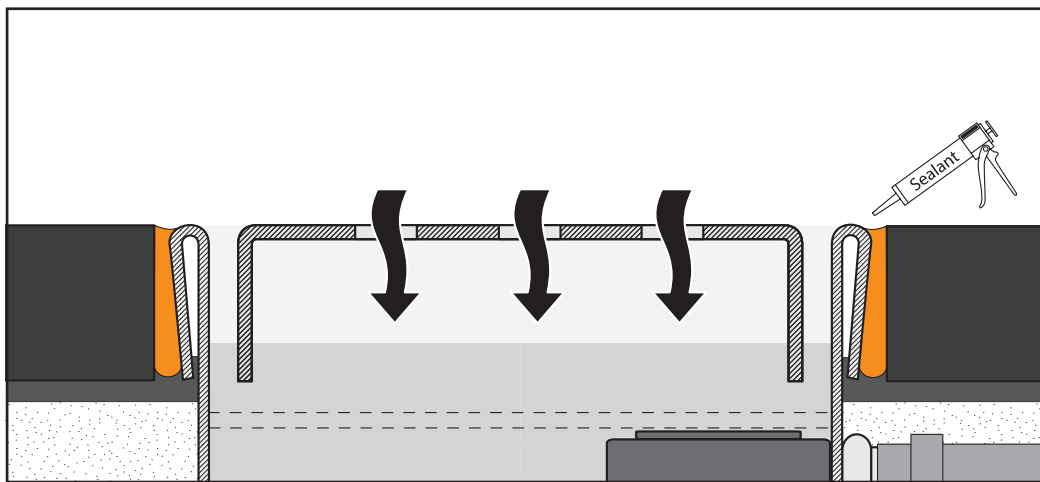

**UK Maintenance instructions****DE** Pflegehinweise**NL** Onderhoudsadviezen**DK** Vedligeholdelsesinstruktioner**NO** Vedlikeholdsinstruks**ES** Instrucciones de mantenimiento**PT** Instruções de manutenção**IT** Istruzioni di manutenzione**FR** Instructions d'entretien**PL** Instrukcja konserwacji

- UK**
- Do not use abrasives and/or sharp/scraping objects to clean the Easy Drain® Compact.
  - The siphon trap should be cleaned periodically to remove any dirt that may have collected.
  - We recommend the use of Easy CLEANSET for daily maintenance and cleaning of your Easy Drain® Compact.
- DE**
- Reinigen Sie den Easy Drain® Compact ohne Scheuermittel und/oder spitze oder scheuernde Gegenstände.
  - Befreien Sie den Geruchsverschluss in regelmäßigen Abständen von eventuellen Verschmutzungen.
  - Wir empfehlen die Verwendung von Easy CLEANSET für die tägliche Reinigung und Pflege Ihrer Easy Drain® Compact.
- NL**
- De Easy Drain® Compact reinigen zonder schuurmiddelen en/of scherpe of schurende voorwerpen.
  - Periodiek het stankslot vrij maken van eventuele vervuilingen.
  - Wij raden het gebruik van Easy CLEANSET aan voor dagelijks onderhoud en intensieve reiniging van uw Easy Drain® Compact.
- DK**
- Rengøring af Easy Drain® Compact skal ske med rengøringsmidler uden slibemiddel, såvel som brugen af spidse eller slibende rengøringsremedier frarådes.
  - Vandlåsen rengøres med jævne mellemrum efter behov.
  - Vi anbefaler anvendelsen af Easy CLEANSET til den daglige rengøring og pleje af Deres Easy Drain® Compact
- NO**
- Rengjør Easy Drain® Compact uten skuremidler og/eller skarpe eller skurende gjenstander.
  - Rengjør med jevne mellomrom vannlåsen for eventuelle forurensninger.
  - Vi anbefaler bruken av Easy CLEANSET for daglig vedlikehold og intensiv rengjøring av din Easy Drain® Compact.
- ES**
- Limpiar el Easy Drain® Compact sin utilizar productos corrosivos y/o materiales abrasivos.
  - Limpiar periódicamente los posibles residuos del cierre hidráulico.
  - Se recomienda el uso de CLEANSET para el mantenimiento diario y limpieza intensiva de su Easy Drain® Compact.
- PT**
- A Easy Drain® Compact não deve ser limpa com produtos abrasivos e/ou objectos afiados ou abrasivos.
  - Periodicamente libertar o sifão de retenção de odores de eventuais sujidades .
  - Recomendamos a utilização do kit de limpeza Easy CLEANSET para a manutenção diária e a limpeza intensiva da sua Easy Drain® Compact.
- IT**
- Pulire la Easy Drain® Compact senza utilizzare sostanze abrasive e/o oggetti taglienti o abrasivi.
  - Eliminare periodicamente le eventuali contaminazioni dal sifone antiodore.
  - Consigliamo di utilizzare Easy CLEANSET per la manutenzione giornaliera e la pulizia approfondita della Easy Drain® Compact.
- FR**
- N'utilisez pas de produit abrasifs ni d'objets coupants ou abrasifs pour le nettoyage du Easy Drain® Compact.
  - Éliminez périodiquement les dépôts éventuels au niveau du coupe-odeur.
  - Nous conseillons d'utiliser Easy CLEANSET pour la maintenance quotidienne et le nettoyage intensif du Easy Drain® Compact.
- PL**
- Easy Drain® Compact czyścić bez użycia materiałów ściernych i/lub ostrych albo szorstkich przedmiotów.
  - Okresowo należy usuwać ewentualne zanieczyszczenia z syfonu kanalizacyjnego.
  - Zalecamy korzystanie z Easy CLEANSET do codziennych zabiegów pielęgnacyjnych oraz intensywnego czyszczenia Easy Drain® Compact.



**UK** Siphon cleaning  
**DE** Siphon Reinigung  
**NL** Sifon reiniging  
**DK** Rengøring af vandlås  
**NO** Vannlåsrensing

**ES** Limpieza sifon  
**PT** Limpeza do sifão  
**IT** Pulizia del sifone  
**FR** Nettoyage du siphon  
**PL** Czyszczenie syfonu

